

better to build · better to operate

Southeast Conference Annual Meeting 2021

Electrification Design Considerations

John Reeves, PE, PMP

Director of Business Development



Southeast Conference



Elliott Bay Design Group

- Naval Architecture / Marine Engineering company based in Seattle, WA

 **4** offices
(WA, AK, LA, NY)

55 
employees

27 Professional
Engineers



7 Project
Managers

www.**ebdg**.com



- Wide-range of experience
 - Vehicle & passenger ferries
 - Fishing vessels
 - Research & workboats
 - Tugs & barges

Energy Density



Spear Lithium-Ion NMC Rack, 124kWh

=



3 Gallons of Diesel, 124kWh

What does Electrification Impact?

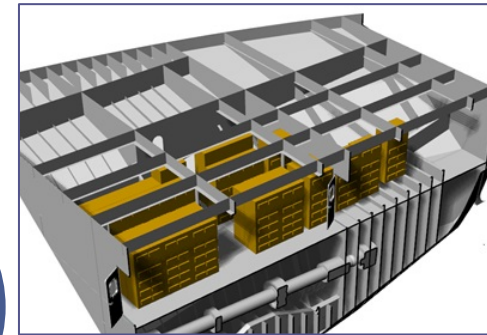
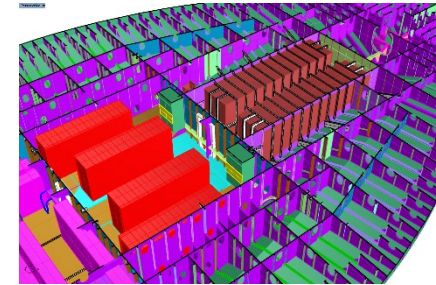
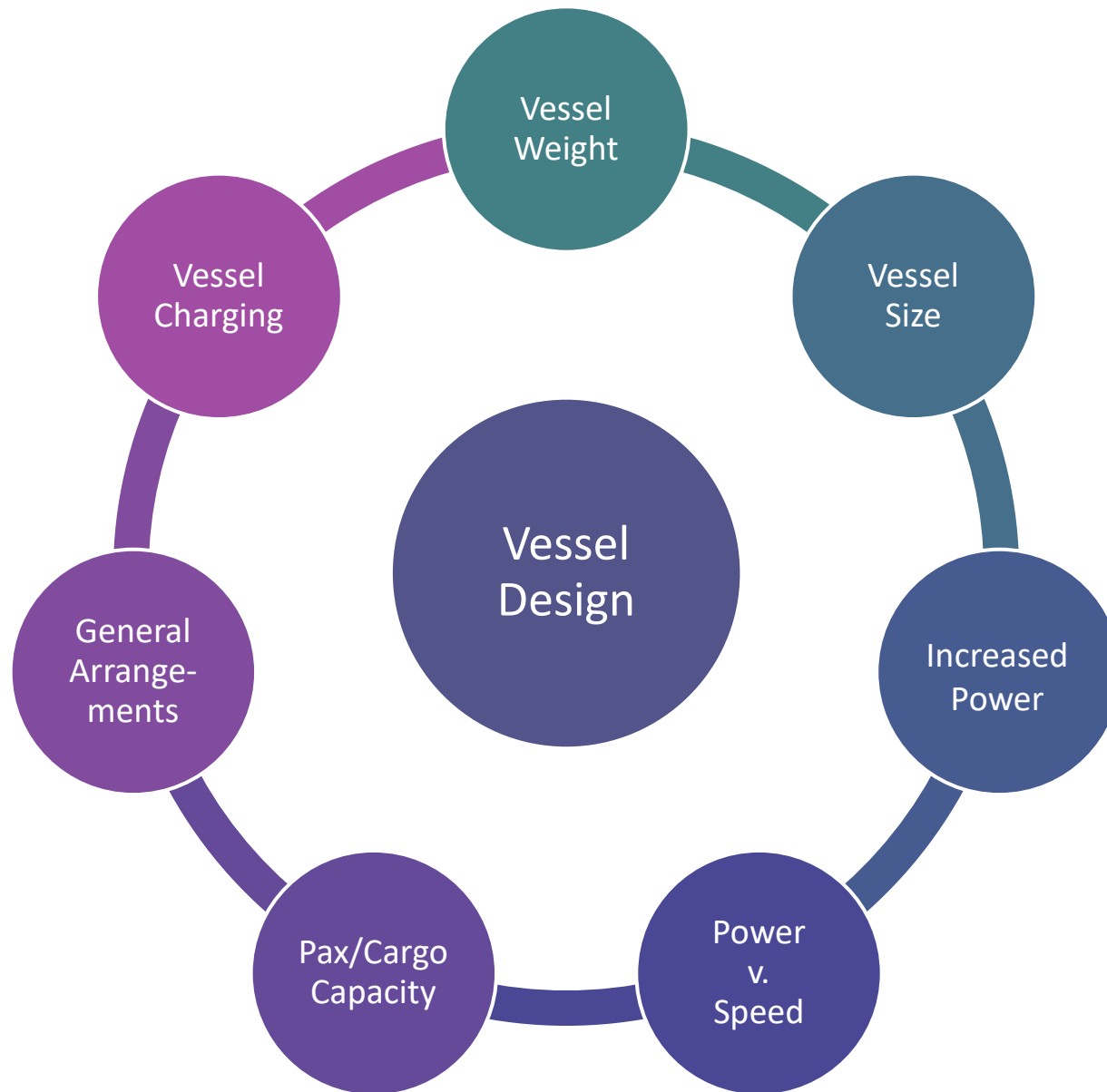

better to build · better to operate

Thank you



Southeast Conference



**Elliott Bay
Design Group**