

# Southeast Conference **ALASKA**

*Modern, Resilient, Agile, and Safe – by Land, Air, and Sea*



***Keep Alaska Moving***

Ryan, Anderson, P.E., Commissioner,  
Department of Transportation and Public Facilities

September 2025



# EMERGENCY RESPONSE

Drone Livestreaming during an event



Alaska DOT drone team livestreamed Juneau's glacial outburst flood to emergency managers

September 5, 2025 by Alex Soliman, KTOO



**ALASKA DOT'S SKYDIO X10 DRONE LIVESTREAMS RECORD-BREAKING FLOOD**

Rafael Solis / September 7, 2025 / Alaska, BYLOS, Department Of Transportation, Drone Technology, Drones, Search And Rescue, Skydio, Specialist

Drone image of Marion Drive during the 2025 DOT

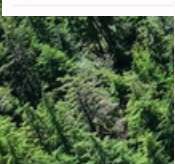

Using drones and sensor systems for faster damage assessments and post-disaster mobility restoration.

Smarter crisis messaging with the launch of 511 Southeast Alaska provides real-time updates tailored to regional travelers.

MODERN

Photo by DOT&PF, Landslide on Tongass Highway, Ketchikan, Alaska - August 25, 2024





# WORKFORCE

## Maritime and Alaska's Youth

STEAMfests are vital for training the next generation of deck, engine, and galley professionals.

### Communities Served

Sitka • Wrangell • Valdez •  
Hoonah • Kake • Ketchikan •  
Juneau • Kodiak (Sept 23–24) •  
Homer (Sept 29–30)

UAF T3 Alaska, the  
Alaska Workforce  
Alliance, and AVTEC,  
used Federal Highways  
504(e) workforce  
funding to bring  
Maritime STEAMfests to  
Alaska's coastal  
communities.

### IMPACT TO DATE

**391** students reached through classroom presentations

**180** students joined ferry tours

**134** students signed up for more information

*Alaskan students now have TWIC cards, several have submitted applications, and completed intro to maritime training.*

RESILIENT

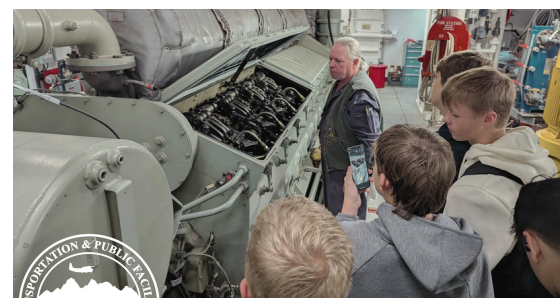



# ALASKA TEAM

## ALASKA DOT&PF TRIBAL RELATIONS

### *Community-Led Transportation*

**COLLABORATION • MUTUAL RESPECT • LASTING RELATIONSHIPS**

**2025**

**New processes to  
strengthen how we:**

Train staff to engage  
respectfully and  
effectively.

Consult with Tribes in  
ways that go beyond  
regulatory requirements.

Build partnerships that ensure  
Alaska Native voices shape  
transportation planning,  
construction, and maintenance.

#### **SHAPE THE PROCESS**

Seeking tribal feedback on how  
we inform how we train staff,  
consult with Tribes, and  
build partnerships.



[dot.tribal.team@alaska.gov](mailto:dot.tribal.team@alaska.gov)

**THE STRONGEST PROJECTS ARE GUIDED BY THE PEOPLE WHO LIVE ALONGSIDE THEM.**

**AGILE**





# Share your User Story



**L RTP 2055**  
*Keep Alaska Moving!*  
**LONG-RANGE TRANSPORTATION PLAN**

**Share your User Story to  
help shape Alaska's  
transportation system!**

*Whether you're a local resident,  
a business owner, a visitor, or  
someone with specific mobility  
needs, your perspective can  
drive meaningful change.*

**VISIT THE WEBSITE  
TO SHARE**

**YOUR USER  
STORY**



 **CLICK TO VIEW**

[publicinput.com/alaskaLRTP2055](https://publicinput.com/alaskaLRTP2055)





# Southeast Conference

Christopher Goins, P.E., Southcoast  
Region Director

September 16, 2025



KEEP ALASKA MOVING



# Southeast Alaska Transportation Plan Update



- 20-year multimodal plan to guide future public investments in transportation infrastructure in Southeast Alaska
- Improve mobility for residents, goods, and services throughout Southeast Alaska, considering area's unique transportation needs and challenges
- Includes all transportation modes, will integrate with the recently adopted Alaska Marine Highway System Long-Range Plan
- Last update was adopted in 2004, so a lot of changes to consider!



# SR Design/Construction Delivery Results

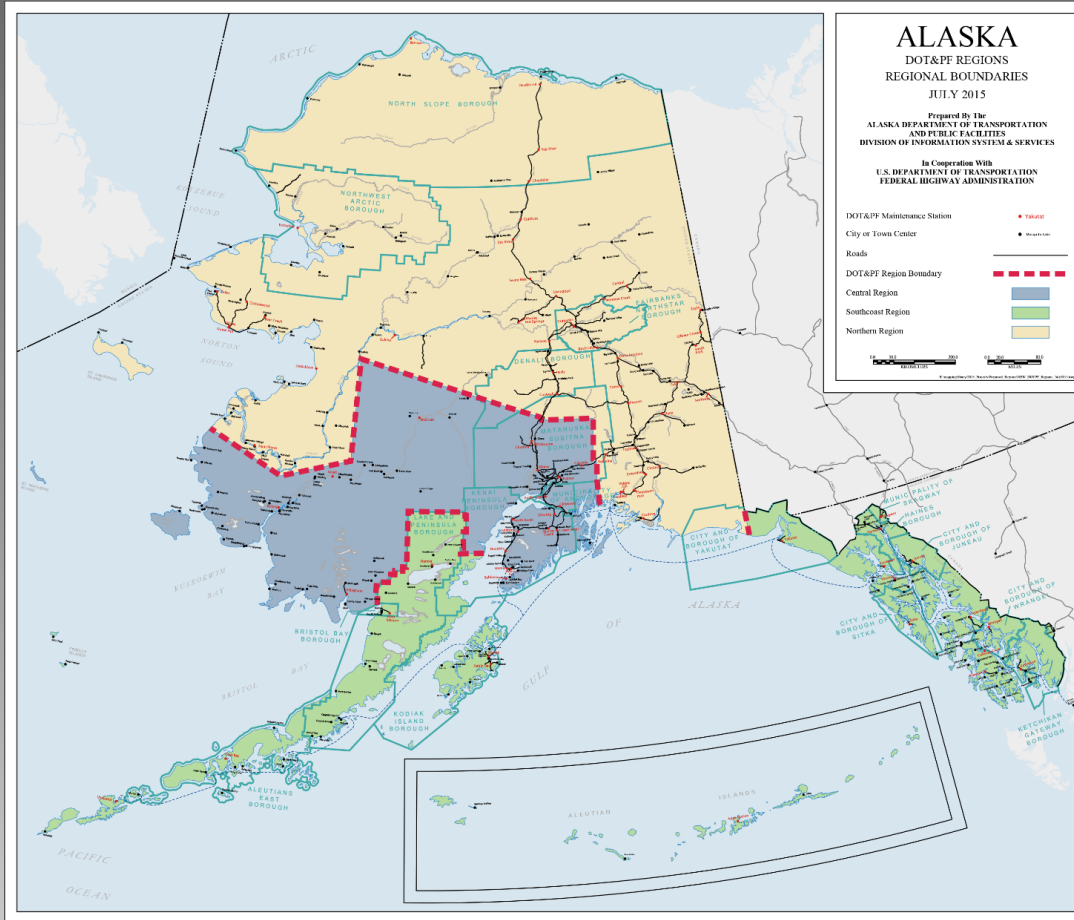

## SOUTHCOAST REGION PROJECT DELIVERY STATS

**Yearly Average Obligated Construction Funding 2020-2023** **\$100 M**

**Construction Funding Obligated 2024** **\$156 M**

**Construction Funding Obligated 2025** **\$206 M**

**Additional Funding Regionally Supported and Obligated** **\$112 M**

**Total Regional Impact 2024 to 2025** **\$474 M**

**Average Yearly % Increase in Regional Production** **183%**

**Average Yearly % Increase in Regional Impact** **236%**



# Regional 10 Year Plan – Forecast by Mode

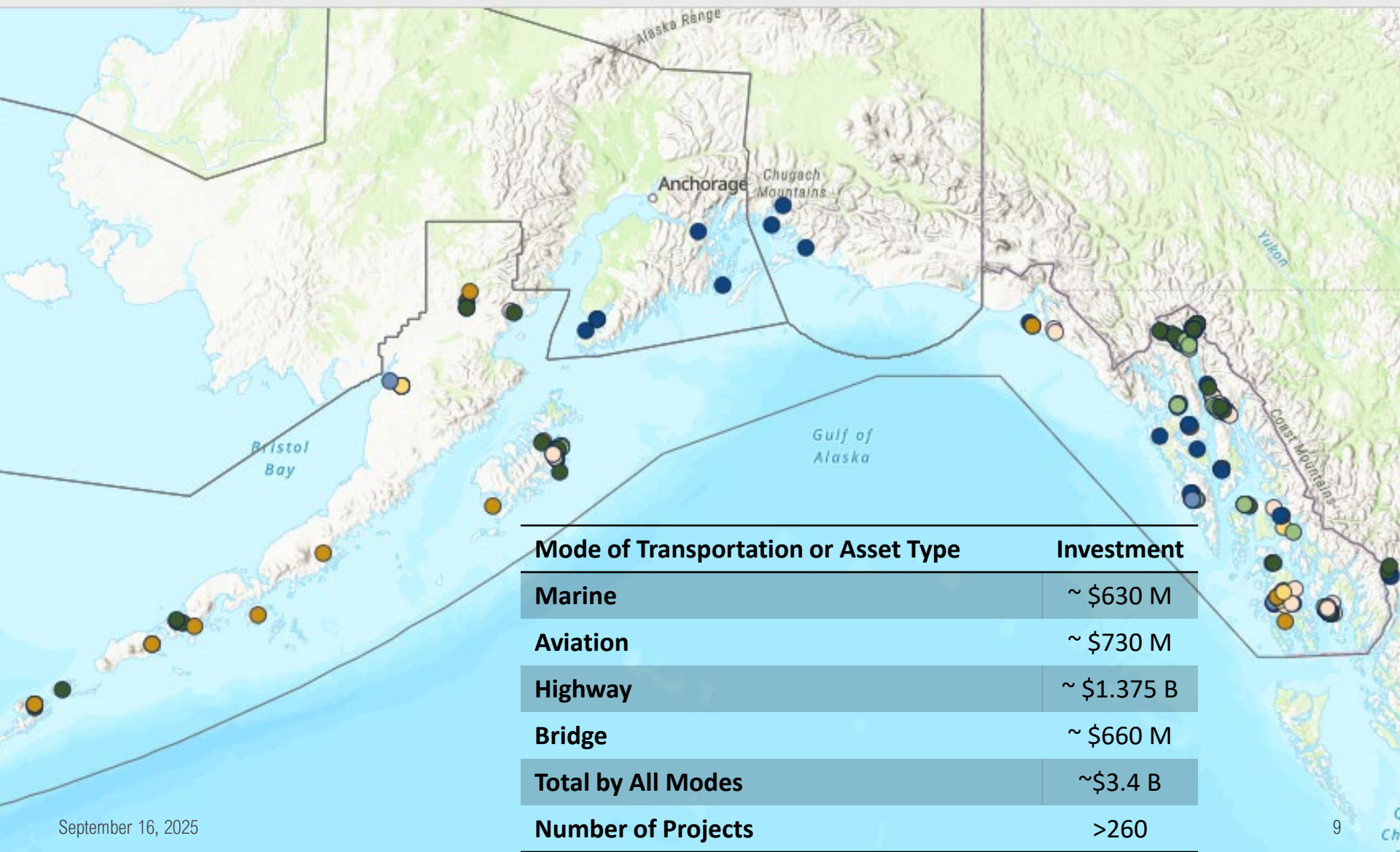



# SR Active Projects - Ketchikan

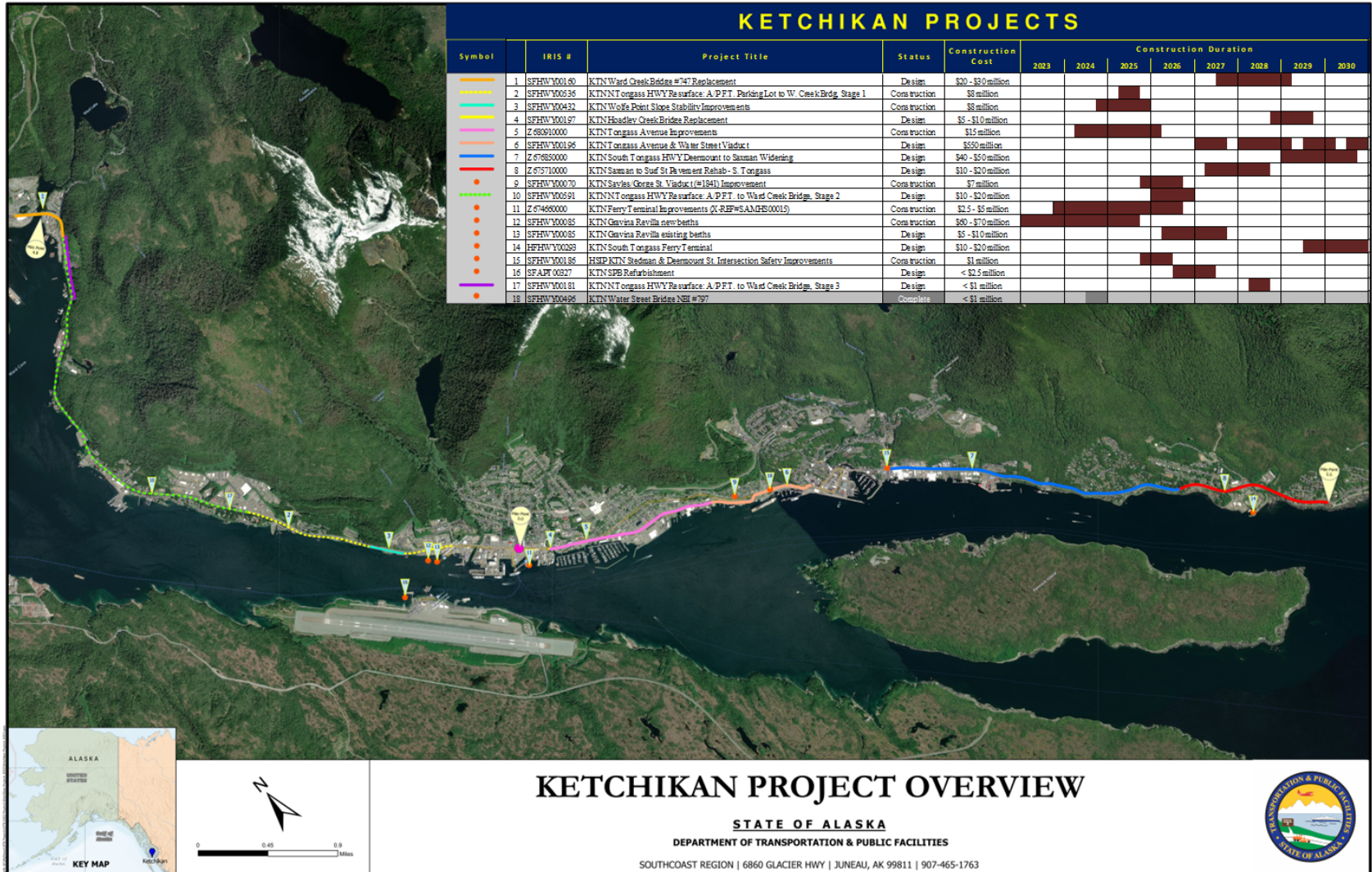



# SR Active Projects

## Tongass Avenue & Water Street Viaducts (Br. 997 & Br 797)

Proposed 10 Projects  
10-Year Schedule

Total Project Funding Need  
~\$550 Million





# SR Active Projects – Egan Yandukin Intersection

Preliminary Concept for Planning Purposes



## Stage 1 (Completed 2024)

Lane reconfiguration and Radar  
Feedback and Seasonal Speed  
Reduction

NO SIGNIFICANT ACCIDENTS

## Stage 2 (Design Underway)

Signal with Protected Left Turns.

Pedestrian Crossing Features

## Stage 3 &4 (Unfunded)

September 16, 2025



## EGAN / YANDUKIN



## Intersection Improvements



# SR Active Projects – Cascade Point Ferry Terminal

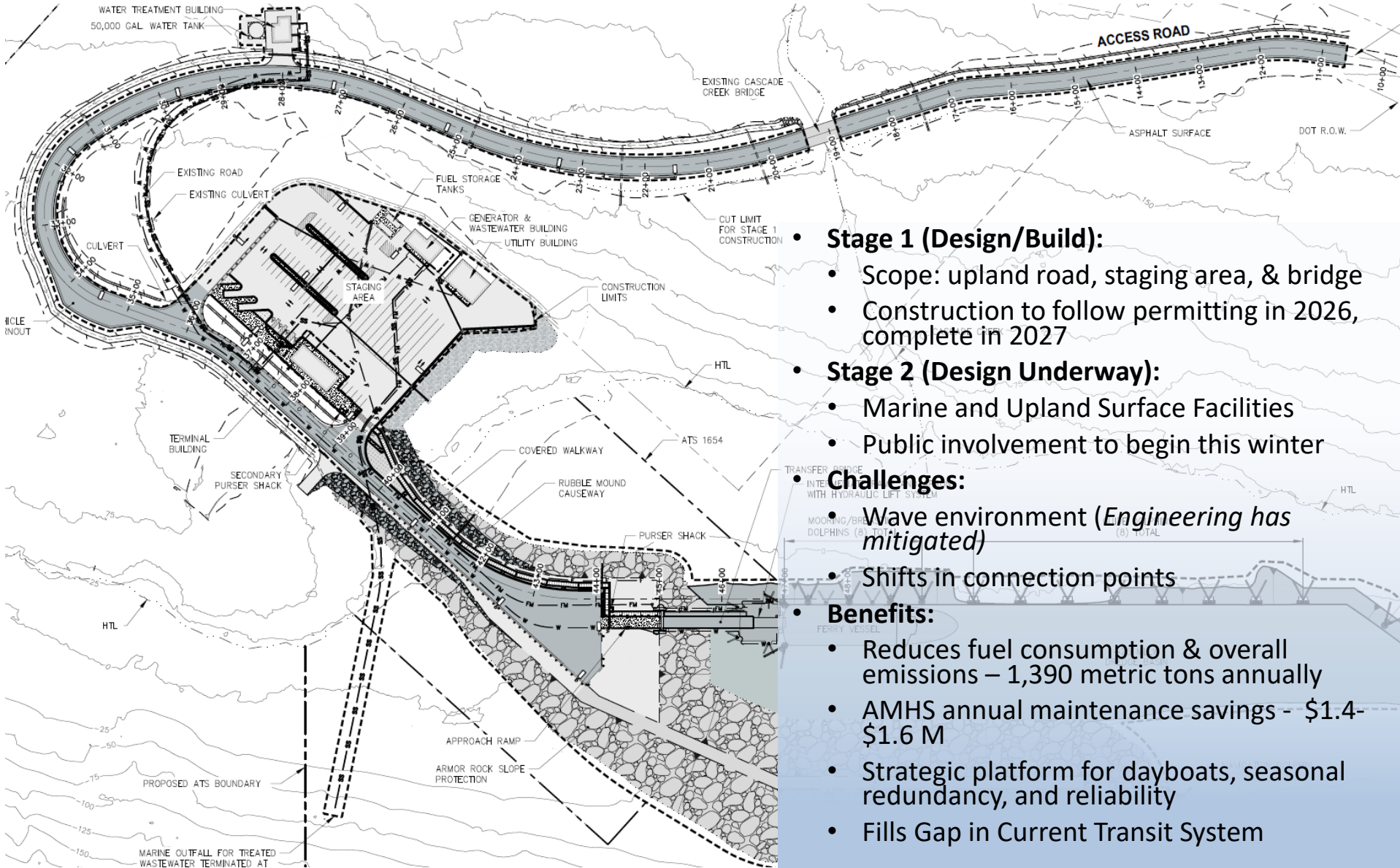

## • Stage 1 (Design/Build):

- Scope: upland road, staging area, & bridge
- Construction to follow permitting in 2026, complete in 2027

## • Stage 2 (Design Underway):

- Marine and Upland Surface Facilities
- Public involvement to begin this winter

## • Challenges:

- Wave environment (*Engineering has mitigated*)
- Shifts in connection points

## • Benefits:

- Reduces fuel consumption & overall emissions – 1,390 metric tons annually
- AMHS annual maintenance savings - \$1.4-\$1.6 M
- Strategic platform for dayboats, seasonal redundancy, and reliability
- Fills Gap in Current Transit System



# Thank You.

Ryan Anderson, P.E.  
Commissioner  
[dot.commissioner@alaska.gov](mailto:dot.commissioner@alaska.gov)  
[dot.alaska.gov](http://dot.alaska.gov)

Christopher Goins, P.E.  
Southcoast Region Director  
[christopher.goins@alaska.gov](mailto:christopher.goins@alaska.gov)  
[dot.alaska.gov/sereg](http://dot.alaska.gov/sereg)



KEEP ALASKA MOVING

Cover photos by Alaska DOT&PF Staff:  
*Sunset departure, Anchorage International Airport.* By Christopher Cummins  
*Alaska Range from the Richardson Highway.* By Dennis Bishop  
*Aboard the MV LeConte sailing Lynn Canal to Juneau from Haines.* By Andrea Deppner